

Use One of These 4 Simple Garden Designs to Grow the 12 Best Kitchen Herbs



Plan 1: Herbal Edging

Sidewalk edging: 9' x 1½', Scale: 0.75" = 1'

Stock the edge of a sidewalk with kitchen herbs to take advantage of the walkway's solid, level ground. As long as only one side of the pathway is densely planted, it won't feel

cramped, and the plants won't interfere with foot traffic. Herbs are color coded by preferred growing method.

The preferred methods to start these 12 herbs are indicated by the colors of their corresponding titles below and in the plans:

Green = sow herb seeds or use transplants

Blue = sow seeds only

Orange = use transplants only

Plan 2: Dooryard Herbs

Straight Sides: 5' x 5'
Stepping Stones (2): 12" x 18"
Scale: 0.75" = 1'

The forerunner of the English cottage garden was a dooryard garden generously planted with kitchen herbs. This triangular kitchen herb garden fits nicely into a corner of your yard. Stepping stones provide easy access to herbs planted in the interior sections of the bed.

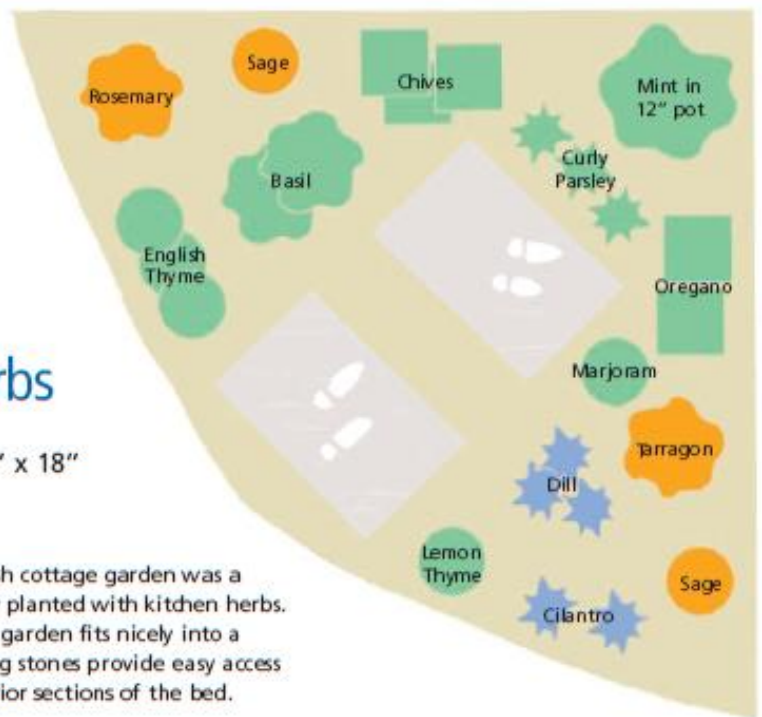

Plan 3: Raised Bed

4' x 3' raised bed, Scale: 0.75" = 1'



Transform a patch of lawn into a compact herb garden by installing a simple raised bed and stocking it with herbs. By keeping the tallest herbs in the center, the edges can support a diverse collection of smaller plants.

The preferred methods to start these 12 herbs are indicated by the colors of their corresponding titles below and in the plans:

Green = sow herb seeds or use transplants

Blue = sow seeds only

Orange = use transplants only

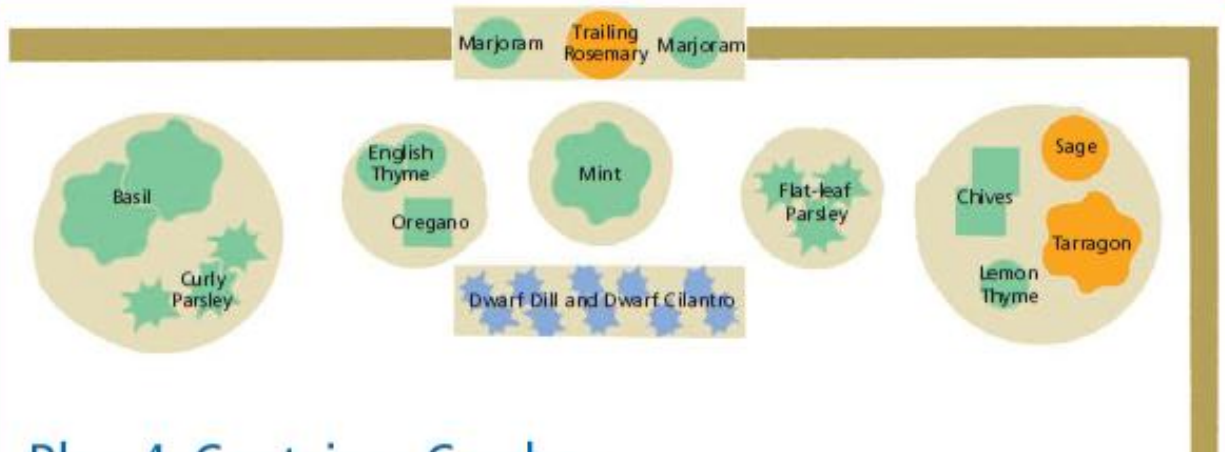

Plan 4: Container Combo

8' x 3' deck or patio area, Scale: 0.75" = 1'

(2) 8" x 24" oblong planters

(2) 18" round planters

(3) 12" round pots

A sunny deck or patio makes a great place to grow kitchen herbs. Combine them in large containers, which require less frequent watering than small ones. Round containers add visual interest when used in dose company with oblong planters.